

Cordless ONE Controls™ Operation and Tension Adjustment Instructions

To Raise the Shade

Give the ring a gentle downward pull and guide the shade straight up assisted by the spring pull mechanism.



To Lower the Shade

Pull the ring straight down and pause to set the shade at the desired height.

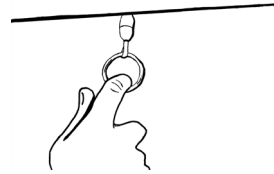

Adjusting Spring Tension

When adjusting the tension on a shade with a valance, work from the FRONT of the shade. When adjusting a Waterfall shade, work from the BACK of the shade.

To Increase Tension

Grasp the tube with the right hand making sure it does not rotate. With your left hand, turn the white ribbed wheel in the direction of the arrow (shown in Figure A) one full turn. Test the shade. Repeat if necessary.

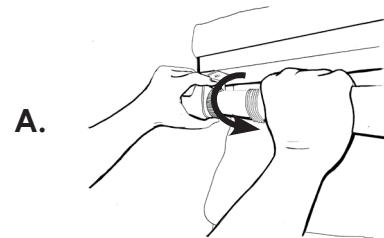

To Decrease Tension

Grasp the tube with right hand and rotate 1/4 turn in the direction of the arrow (shown in Figure B) to unlock the spring. With your left hand, turn the white ribbed wheel one full turn in the same direction. Test the shade. Repeat if necessary.

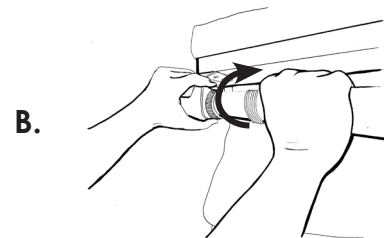

Releasing Shade

If the Shade is stuck in the Down Position

Grasp the white ribbed wheel and turn in the direction of the arrow (shown in Figure C) 1/4 turn. **Do not grasp the tube.** This will realign the stop mechanism to the correct position. If additional adjustment is needed, turn the ribbed wheel an additional 1/8 of a turn.

