

How To Change the Chain on a Horizons™ UpRight™ Romans Shade

(No tools required!)

Taking Off The Old Chain

1. Release the chain from any safety/tie-down device.

2. Form a small loop in the chain (A) and pass it over the guide bar (B).

3. Holding the loop like a handle, use it to rotate the cog, releasing the balls of the chain from the teeth of the cog as you go (B - D).

4. Once the chain is completely off the cog, slide it off of the guide bar (E).

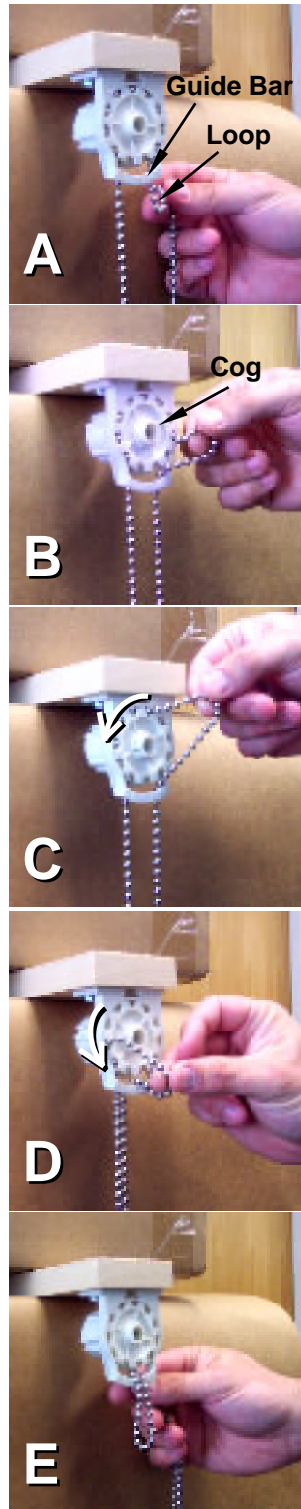

Putting On The New Chain

1. Slip a loop of the new chain over the guide bar (G).

2. Holding the loop like a handle, feed the chain into the teeth of the cog, rotating the cog as you go (H - J).

3. Once the chain is completely in the cog, pull the loop off of the guide bar (K).

4. Reattach any safety/tie-down device.

